

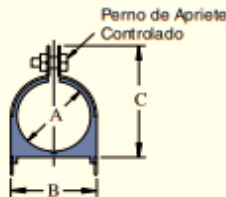

004T008 a 098N106
009N012 a 106N114

CUSH-A-CLAMP® Ensemble

Serie para Cañerías

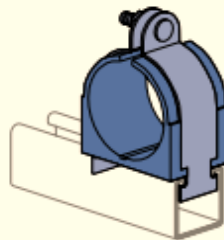

Cojinete, abrazadera perno y tuerca incluidos

Número de Pieza	Cañería de cobre y acero Diam. Ext.	Cañería de cobre para agua (Nominal)	*A*		*B*		*C*		Peso por cien	
			Pulg	mm	Pulg	mm	Pulg	mm	Lbs	kg
004T008	1/4		.25	6.4	.62	15.7	.98	24.9	10	4.5
006T010	3/8	1/4	.37	9.4	.82	20.8	1.13	28.7	11	5.0
008T012	1/2	3/8	.50	12.7	.94	23.9	1.34	34.0	13	5.9
010T014	5/8	1/2	.62	15.7	1.06	26.9	1.54	39.1	14	6.4
012T016	3/4	5/8	.75	19.1	1.20	30.5	1.68	42.7	14	6.4
014T018	7/8	3/4	.87	22.1	1.31	33.3	1.82	46.2	15	6.8
016T020	1		1.00	25.4	1.44	36.6	1.95	49.5	17	7.7
018T022	1 1/8	1	1.12	28.4	1.57	39.9	2.08	52.8	18	8.2
020T024	1 1/4		1.25	31.8	1.70	43.2	2.21	56.1	18	8.2
022T026	1 3/8	1 1/4	1.37	34.8	1.82	46.2	2.34	59.4	20	9.1
024N028	1 1/2		1.50	38.4	1.95	49.5	2.47	62.7	33	15.0
026N030	1 5/8	1 1/2	1.62	41.1	2.07	52.6	2.60	66.0	35	15.9
028N032	1 3/4		1.75	44.5	2.20	55.9	2.73	69.3	37	16.8
030N034	1 7/8		1.87	47.5	2.32	58.9	2.86	72.6	39	17.7
032N036	2		2.00	50.8	2.45	62.2	3.04	77.2	46	20.9
034N040	2 1/8		2.12	53.8	2.57	65.3	3.23	82.0	47	21.3
038N044	2 3/8		2.37	60.2	2.82	71.6	3.67	93.2	49	22.2
040N046	2 1/2		2.50	63.5	2.94	74.7	3.79	96.3	51	23.1
042N048	2 5/8		2.62	66.5	3.07	78.0	3.92	99.6	55	24.9
046N052	2 7/8		2.87	72.9	3.32	84.3	4.17	105.9	57	25.9
050N056	3		3.12	79.2	3.57	90.7	4.42	112.3	60	27.2
056N062	3 1/2		3.50	88.9	3.95	100.3	4.79	121.7	55	24.9
058N064	3 3/8		3.62	91.9	4.20	106.7	4.99	126.7	70	31.8
064N072	4		4.00	101.6	4.45	113.0	5.42	137.7	88	39.9
066N074	4 1/8		4.12	104.6	4.57	116.1	5.54	140.7	94	42.6
072N080	4 1/2		4.50	114.3	4.95	125.3	5.92	150.4	110	49.9
082N090	5 1/8		5.12	130.0	5.57	141.5	6.54	166.1	125	56.7
098N106	6 1/8		6.12	155.4	6.57	166.9	7.54	191.5	130	59.0

Serie para Tuberías

Número de Pieza	Diámetro Nominal para Tubería	*A*		*B*		*C*		Peso por cien	
		Pulg	mm	Pulg	mm	Pulg	mm	Lbs	kg
009N012	1/4	.54	13.7	.98	24.9	1.34	34.0	13	5.9
011N014	3/8	.67	17.0	1.13	28.7	1.54	39.1	14	6.4
014N018	1/2	.84	21.3	1.29	32.8	1.82	46.2	15	6.8
017N022	3/4	1.05	26.7	1.50	38.1	1.95	49.5	17	7.7
021N026	1	1.31	33.3	1.76	44.7	2.34	59.4	19	8.6
027N032	1 1/4	1.66	42.2	2.17	55.1	2.73	69.3	35	15.9
030N034	1 1/2	1.90	48.5	2.35	59.7	2.86	72.6	41	18.6
038N044	2	2.37	60.2	2.82	71.6	3.67	93.2	49	22.2
046N052	2 1/2	2.87	72.9	3.32	84.3	4.17	105.9	57	25.9
056N062	3	3.50	88.9	3.95	100.3	4.79	121.7	55	24.9
064N072	3 1/2	4.00	101.6	4.45	113.0	5.42	137.7	88	39.9
072N080	4	4.50	114.3	4.95	125.3	5.92	150.4	110	49.9
089N096	5	5.56	141.2	6.01	152.7	6.92	175.8	130	59.0
106N114	6	6.62	168.1	7.07	179.6	8.23	209.0	140	63.5

Materiales:
Revestimiento: electro-galvanizado o acero inoxidable
Cojinete: elastómero termoplástico

Los números de piezas indican tamaño del cojinete y abrazadera.

Ejemplo: **004T008** 004 - Tamaño cojinete 1/4" (6.4)
T - Con perno de apriete controlado
008 - Tamaño abrazadera 3/8" (12.7)

009N012 009 - Tamaño cojinete 1/4" (14.3)
N - Con perno estándar
012 - Tamaño abrazadera 1/2" (19.1)